

**AERODROME CHART - ICAO**

ARP 502522N 0040621W

AD ELEV 476FT

**PLYMOUTH EGH**

**GUND** (Geoid Undulation) =  
The height of the Geoid (MSL) above the  
Reference Ellipsoid (WGS 84) at the stated position.  
**BEARINGS ARE MAGNETIC  
ELEVATIONS AND HEIGHTS ARE IN FEET  
ELEVATIONS IN FEET AMSL  
HEIGHTS IN FEET ABOVE AD**

**I-PLY 109.50°**  
502533.77N 0040649.80W

Mobile Obstacle  
Vehicles 481 (5)

**PLYMOUTH I-PLY**  
109.50°  
(Ch 32X)  
502527.67N 0040642.85W  
494

**PY 396.5**  
502527.64N 0040644.51W

**VAR 3.0°W - 2009**  
N  
Annual Rate  
of Change 0.14° E

<b>COM</b>	118.150	PLYMOUTH TOWER
TWR	121.600	PLYMOUTH FIRE
<b>LIGHTING</b>		
APCH 31	900m HI coded C/L. 5 crossbars.	
THR 13/31	HI green.	
RWY 13/31	HI omni-d edge. End lights red.	
TWY	Blue edge.	
<b>RUNWAY/TAXIWAY/APRON PHYSICAL CHARACTERISTICS</b>		
<b>APRON / RWY / TWY</b>	<b>SURFACE</b>	<b>BEARING STRENGTH</b>
RWY 13/31	Asphalt	14/FAY/T
Main Apron	Concrete/Asphalt	-
Taxiways A, B, D	Asphalt	-
Taxiway C	Asphalt	11/F/CYU

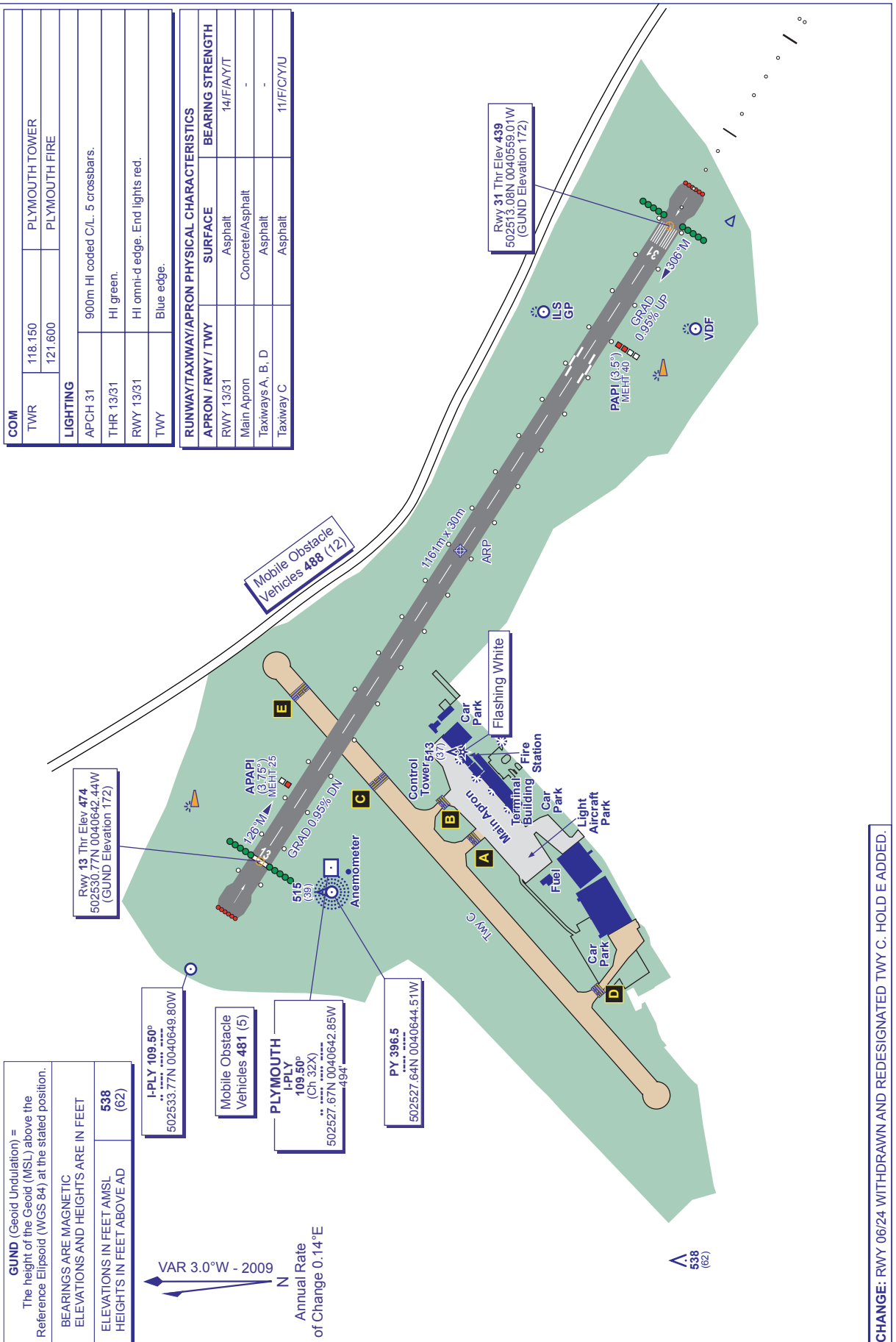

CHANGE: RWY 06/24 WITHDRAWN AND REDESIGNATED TWY C. HOLD E ADDED.

AERO INFO DATE 15 SEP 09