

EGBK AD 2.1 **EGBK** **NORTHAMPTON/SYWELL**

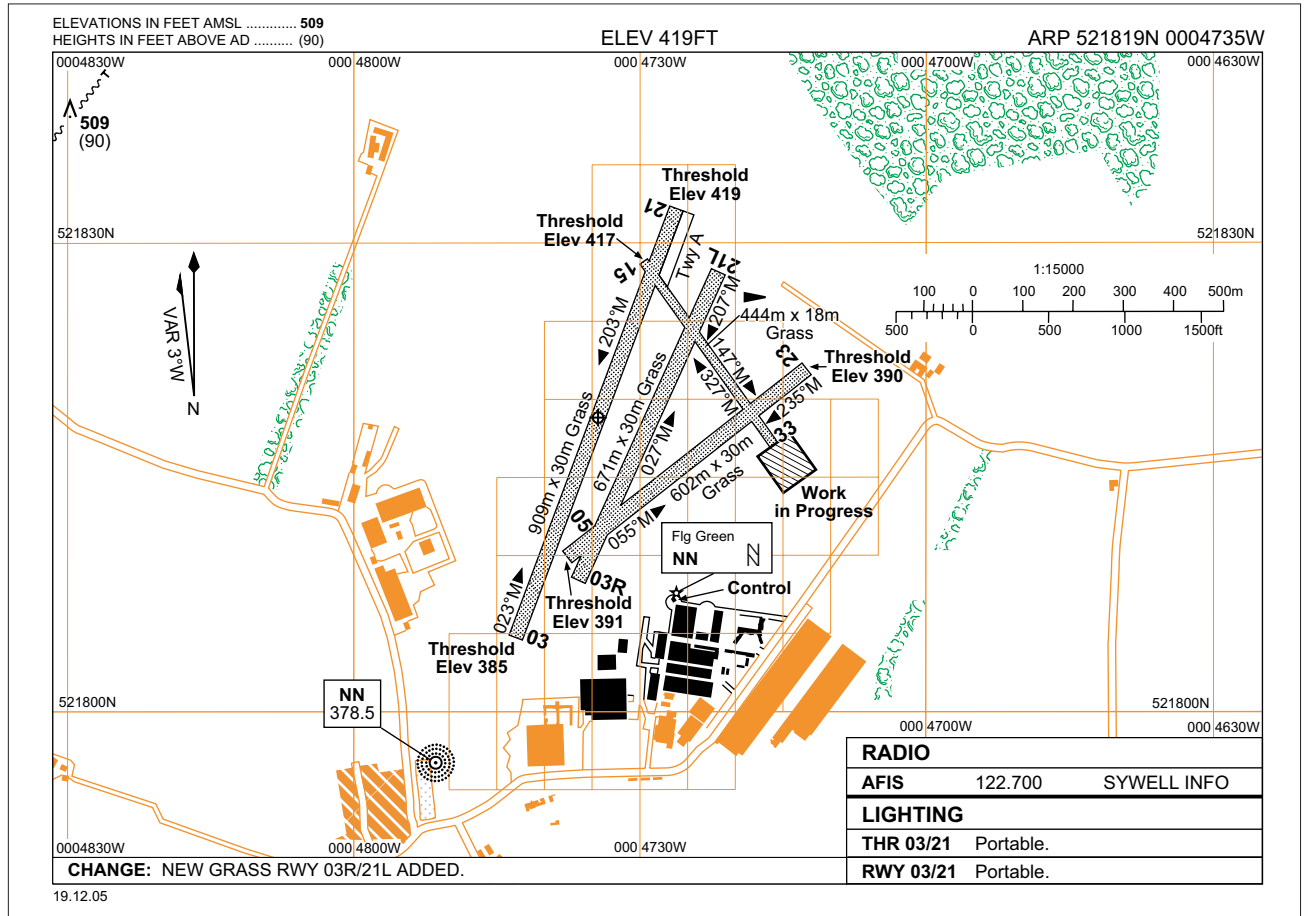

EGBK AD 2.2 – AERODROME GEOGRAPHICAL AND ADMINISTRATIVE DATA

2	Direction and distance from city:	5 nm NE of Northampton.
4	Geoid undulation at AD Elevation Psn:	
5	Magnetic Variation/Annual Change:	W2.6° (2006) – 0.14° decreasing.
6	AD Administration:	Sywell Aerodrome Ltd.
	Address:	Sywell Aerodrome, Northampton, NN6 0BT.
	Telephone:	01604-644917.
	Fax:	01604-499210.
7	Type of Traffic Permitted (IFR/VFR):	

EGBK AD 2.3 – OPERATIONAL HOURS

1	AD:	Winter: 0900-1700 or SS; and by arrangement. Summer: 0800-1700 or SS whichever is the earlier; and by arrangement.
2	Customs and Immigration:	By arrangement.
7	ATS:	As AD hours. See also AD 2.18.
8	Fuelling:	
12	Remarks:	This aerodrome is PPR via telephone or RTF.

EGBK AD 2.4 – HANDLING SERVICES AND FACILITIES

2	Fuel/oil types:	Fuel: AVTUR JET A-1, AVGAS 100LL, MOGAS. Oil: W100, W80.
3	Fuelling facilities/capacity:	

EGBK AD 2.6 – RESCUE AND FIRE FIGHTING SERVICES

1	AD Category for fire fighting:	RFF Category 1.
3	Capability for removal of disabled aircraft:	

EGBK AD 2.10 – AERODROME OBSTACLES

In Approach/Take-off areas				In circling area and at aerodrome		
1				2		
Runway/Area affected	Obstacle type Elevation Markings/lighting	Co-ordinates		Obstacle type Elevation Markings/lighting	Co-ordinates	
a	b		c	a	b	
		ft amsl			ft amsl	
21/Approach 03/Take-off	Trees	455	*521844N 0004718W	Pylons Trees	509 449- 489	*521844N 0004821W (within 0.2 nm from all boundaries)
33/Approach 15/Take-off	Vehicles on road	403	*521811N 0004708W			
3	Remarks:					

EGBK AD 2.12 – RUNWAY PHYSICAL CHARACTERISTICS

Designations RWY Number	True bearing	Dimensions of RWY (m)	Strength (PCN) and surface of RWY and stopway	THR co-ordinates RWY end co-ordinates THR Geoid undulation	THR elevation Highest elevation of TDZ of precision APP RWY
1	2	3	4	5	6
03L	020.50°	909 x 30	Grass	*521805.10N 0004743.16W - GUND	THR 385 ft
21R	200.50°	909 x 30	Grass	*521832.86N 0004726.23W - GUND	THR 419 ft
03R	024.55°	671 x 30	Grass	*521808.59N 0004736.43W - GUND	THR 389 ft
21L	204.56°	671 x 30	Grass	*521828.34N 0004721.71W - GUND	THR 410 ft
15	144.20°	444 x 18	Grass	*521829.29N 0004730.06W - GUND	THR 417 ft
33	324.20°	444 x 18	Grass	*521815.19N 0004713.44W - GUND	THR 384 ft
05	051.90°	602 x 30	Grass	*521810.35N 0004737.65W - GUND	THR 391 ft
23	231.90°	602 x 30	Grass	*521822.38N 0004712.62W - GUND	THR 390 ft
Slope of RWY/SWY	Stopway Dimensions (m)	Clearway Dimensions (m)	Strip Dimensions (m)	OFZ	
7	8	9	10	11	
12	Remarks:				

EGBK AD 2.13 – DECLARED DISTANCES					
Runway Designator	TORA (m)	TODA (m)	ASDA (m)	LDA (m)	Remarks
1	2	3	4	5	6
03L 21R	909 909	909 909	909 909	909 909	
03R 21L	671 671	671 671	671 671	671 671	
05 23	602 602	602 602	602 602	602 602	
15 33	528 528	528 528	528 528	528 528	



EGBK AD 2.17 – ATS AIRSPACE		
Designation and lateral limits	Vertical limits	Airspace Classification
1	2	3
Northampton/Sywell Aerodrome Traffic Zone (ATZ) Circle radius 2 nm centred on longest notified runway (03/21) 521819N 0004735W.	2000 ft aal SFC	G †
4 ATS unit callsign: Language: 5 Transition Altitude: 6 Remarks:	Sywell Information. English. † Refer to Section ENR 1.4 for Notifications. See AD 2.18 for ATZ hours.	

EGBK AD 2.18 – ATS COMMUNICATION FACILITIES					
Service Designation	Callsign	Frequency MHz	Hours of Operation		Remarks
			Winter	Summer	
1	2	3	4		5
AFIS	Sywell Information	122.700	0900-1700 or SS and by arrangement	0800-1700 or SS whichever is earlier and by arrangement	ATZ hours coincident with AFIS hours but not by arrangement.

EGBK AD 2.19 – RADIO NAVIGATION AND LANDING AIDS							
Type of Aid MAG VAR CAT of ILS/MLS	IDENT	Frequency	Hours of Operation		Position of transmitting antenna co-ordinates	Elevation of DME transmitting antenna	Remarks
			Winter	Summer			
1	2	3	4		5	6	7
NDB	NN	378.5 kHz	0900-1700 or SS; Sat 0800-1400.	0800-1700 or SS; Sat 0700-1300. whichever is earlier	*521756.73 0004751.37W		Range 15 nm Normally radiates H24.

EGBK AD 2.20 – LOCAL TRAFFIC REGULATIONS

1 Aerodrome Regulations

- a Only Runway 03/21 is licensed for night use.

4 Warnings

- a A public road runs along the southeast, south and southwest boundaries.
- b The aerodrome is used by significant numbers of light helicopters in the training role. Helicopter circuit flying takes place on the 'dead-side' and parallel to the active runway up to 700 ft agl.
- c The Southern edge of Runway 03/21, and the northern edge of Runway 15/33 are marked with a number of two metre square white ground marks. These are associated with helicopter operations and should be disregarded by fixed-wing aircraft pilots.
- d All runways are marked by non-standard white chalk centre-line markings.
- e Runway designators for 03/21 and 15/33 lie outside the marked runway.

EGBK AD 2.22 – FLIGHT PROCEDURES

- a Fixed-wing circuit directions: Runways 05, 21 and 33 - RH; Runways 03, 15 and 23 - LH.
Fixed-wing circuit height: 1000 ft agl.
- b Helicopter training circuits are opposite direction to fixed-wing circuits and are flown up to 700 ft agl on the 'dead-side' of the active runway.